

**Pressure measuring transducers, incl. DIN plug-in connectors and mounting angle, with active output**

The pressure sensor / differential pressure sensor **PREMASGARD® SHD-692** is used for pressure measurement in gaseous and liquid media. It converts the measurand into standard signals of 0-10V or 4...20mA. Process connection is 2 x G 1/8" - 27 NPT internal thread. SHD-692 differential pressure transmitters are used in piping and hydraulic systems, in mechanical and plant engineering as well as in building automation.

**Not applicable for ammonia and freon!**

The device variant **SHD 692-xx-LCD** is supplied with the display module **LCD-SHD**. The installation takes place below the angle plug. The module can be mechanically rotated and tilted, and the display content can be rotated in 90° increments to achieve the ideal reading position. The display types and pressure units are configured directly on the display (menu-controlled via buttons).

**SHD 692-xx-LCD**  
with display module



**TECHNICAL DATA**

Power supply:	24 V AC (+15% / -10%), 18 - 33V DC for U-variant 24 V DC (± 20%) for I-variant
Measuring ranges:	see table
Output:	0-10 V (3-wire connection) or 4...20 mA (2-wire connection)
Permissible working resistance: (at nominal voltage)	R <sub>L</sub> > 10 kΩ for U-variant R <sub>L</sub> < 600 Ω for I-variant
Electrical connection:	0.2 - 1.5 mm <sup>2</sup> , via plug-in connector DIN EN 175301-803-A (included in the scope of delivery)
Pressure connection:	screw pipe connection for 6 mm pipe (G 1/8" - 27 NPT internal thread)
Type of pressure:	differential pressure
Measuring principle:	<b>ceramic measuring cell</b>
Medium:	liquid or gaseous
Temperature of medium:	-15...+80 °C
Housing:	stainless steel <b>V2A</b> (1.4305)
Mounting:	by mounting angle (included in the scope of delivery), installation arbitrary
Medium contacting parts:	INOX (1.4305), ceramics, sealing material EPDM
Response time:	< 5 ms
Class:	0.5%
Total error:	< 1.3%
Overload range:	see table (one-sided max. pressure)
System pressure:	max. 25 bar (P1 + P2)
Bursting pressure:	1.5 x system pressure
Insulating resistance:	≥ 100 MOhm, at +20 °C (500V DC)

**SHD 692-xx-LCD**

Display:	<b>display module LCD-SHD</b> , rotatable and tiltable, made of plastic, flame retardant (UL 94 V-0), PC/ABS material, colour black (similar to RAL 9004), housing cover is transparent, for displaying the <b>ACTUAL</b> pressure, min / max pressure or standard signal of the sensor
Display content:	pressure [bar] [kPa] [psi] [inWC] [mWC] [atm] power [V] or current [mA]
System of unitsv:	<b>SI and Imperial</b> (display configurable)
Protection class:	III (according to EN 60 730)
Protection type:	<b>IP 65</b> (according to EN 60 529)
Standards:	CE conformity according to EMC Directive 2014 / 30 / EU

Dimensional drawing [mm] **SHD 692** Mounting angle

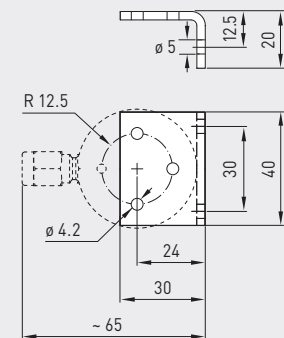

Connecting diagram

**SHD 692-U**

- 2 Output pressure 0-10V
- 3 GND
- 1 Supply voltage UB+ 24V AC / 18-33V DC

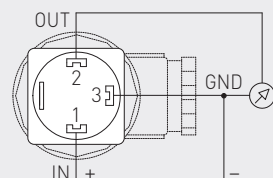

Connecting diagram

**SHD 692-I**

- 2 Output pressure 4...20mA
- 3 Free
- 1 Supply voltage UB+ 24V DC

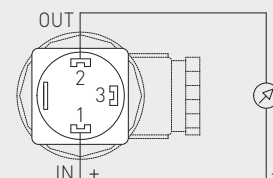



**NEW**

S+S REGELTECHNIK

PREMASGARD® SHD 692

Pressure measuring transducers,  
incl. DIN plug-in connectors and mounting angle,  
with active output

Dimensional drawing  
[mm]

SHD 692

SHD 692

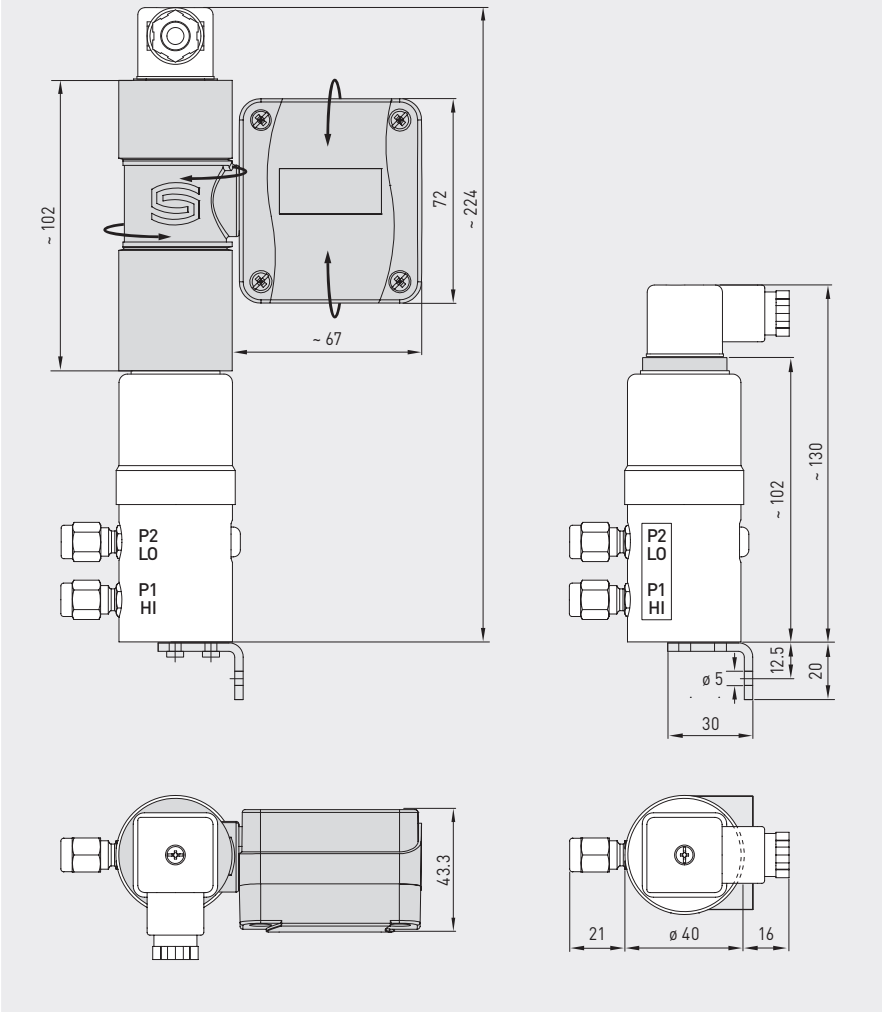

**PREMASGARD® SHD 692** Pressure measuring transducers, *Deluxe* or gaseous and liquid media

Measuring Range	One-sided max. pressure	Type / WG02	Display	Item No.	Item No.	Price
				Output 0-10V	Output 4...20mA	
<b>SHD 692-x = U / I</b>						
0...0,1 bar	0,6 bar	SHD 692-x-900		1301-4121-0500-000	1301-4122-0500-000	<b>377,92 €</b>
		SHD 692-x-900-LCD	■	1301-4121-5500-201	1301-4122-5500-101	<b>580,72 €</b>
0...0,5 bar	3 bar	SHD 692-x-907		1301-4121-0510-000	1301-4122-0510-000	<b>377,92 €</b>
		SHD 692-x-907-LCD	■	1301-4121-5510-201	1301-4122-5510-101	<b>580,72 €</b>
0... 1 bar	5 bar	SHD 692-x-912		1301-4121-0520-000	1301-4122-0520-000	<b>377,92 €</b>
		SHD 692-x-912-LCD	■	1301-4121-5520-201	1301-4122-5520-101	<b>580,72 €</b>
0...2,5 bar	12 bar	SHD 692-x-916		1301-4121-0530-000	1301-4122-0530-000	<b>377,92 €</b>
		SHD 692-x-916-LCD	■	1301-4121-5530-201	1301-4122-5530-101	<b>580,72 €</b>
0... 4 bar	12 bar	SHD 692-x-918		1301-4121-0540-000	1301-4122-0540-000	<b>377,92 €</b>
		SHD 692-x-918-LCD	■	1301-4121-5540-201	1301-4122-5540-101	<b>580,72 €</b>
0... 6 bar	12 bar	SHD 692-x-919		1301-4121-0550-000	1301-4122-0550-000	<b>377,92 €</b>
		SHD 692-x-919-LCD	■	1301-4121-5550-201	1301-4122-5550-101	<b>580,72 €</b>
0... 10 bar	20 bar	SHD 692-x-930		1301-4121-0560-000	1301-4122-0560-000	<b>377,92 €</b>
		SHD 692-x-930-LCD	■	1301-4121-5560-201	1301-4122-5560-101	<b>580,72 €</b>

**Note:** Not suitable for ammonia and freon!